

**I.B.S.<sup>®</sup>**

# Innovative Bone Synthesis Overview



*A range of combined single-use and re-useable instrument sets for foot surgery*

**ATHRODAX**  
HEALTHCARE INTERNATIONAL LTD

# The first combination of Single-Use and Re-usable instrument sets for Foot surgery in the UK

## NEOSYS® Reusable Instrument Sets on Consignment or Hire

**Consignment sets placed for FREE-** Complete Reusable metal Instrument sets for FOREFOOT, MID & HIND FOOT procedures . Instruments of the highest quality and design, containing every instrument required for total foot surgery.

Available for all Compression Implant sizes:- 2.0mm, 2.5mm, 3.0mm, 3.5mm ALSO for larger IBS Screw implants for Mid & Hind Foot - 4.5mm to 8.0 mm.

These highly, contemporary Reusable Metal sets are supported by the innovative - Off - the Shelf Single- use solution ....

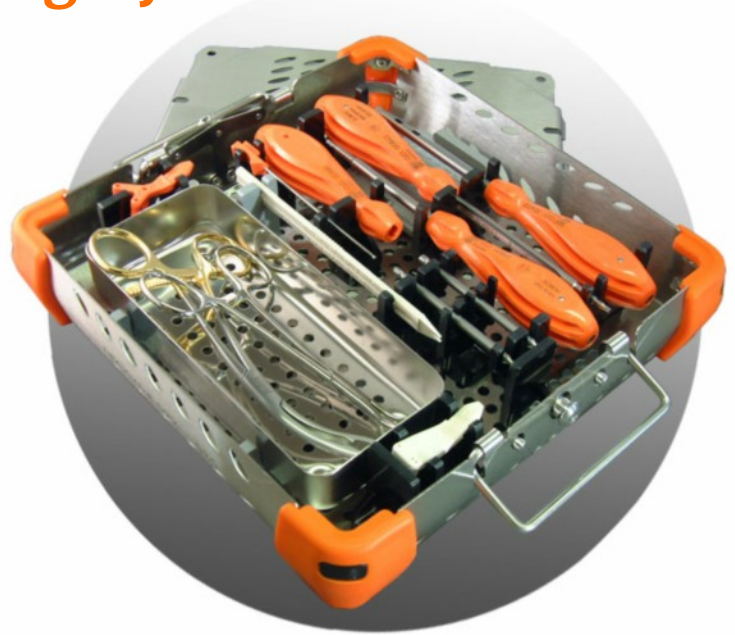

## NEOSYS® Single Use instrument system

Incorporates modern polymer technology, specifically designed for single use. This single use solution guarantees equipment that is always sterile, complete for purpose and convenient to use.

### Surgical Effectiveness

- Always new, **GUARANTEED COMPLETE SETS** of instruments give guaranteed performance to the surgeon
- Logical layout of the kit - easy, intuitive identification of the components
- Simple layout & complete range of screws - colour coded ( Compression, Neutralization & Snap off)
- Presentation of screws easy to open and handover
- Easy to check contents before disposal
- Manual use of instruments in set (no power tools necessarily required)

### Sterilisation Savings

- In2Bones single use sets will provide tangible savings for theatre spend, when typical sterilisation costs, costs of using drills, transportation costs, dirty or missing instrumentation and cancelled procedures are all taken into consideration.
- Pre-op & post op costs as well as sterilisation issues are limited
- Reduction in additional kit required in theatre, power tools, extra trolleys, extra instrument trays
- Traceability for instruments and implants are improved

The **NEOSYS Single Use System** is complemented by a range of IBS Screws - **Compression** 2.0, 2.5, 3.0, 3.5 mm & **Neutralisation** 2.5, 3.0, 3.5 mm. For Mid & Hind Foot applications - **Compression & Neutralisation** 4.5, 6.5, 8.0 mm and **Snap-off** 2.2, 2.7 mm and staples (static & compression), providing a complete system, appropriate for most common clinical situations. All screws are presented in sterile tubes - colour coded.

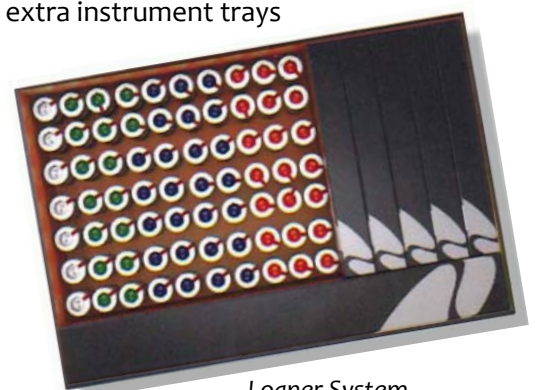

Loaner System

### Theatre Planning

- Organisation of consignment management

### No initial set up costs - FREE consignment sets

- Immediate availability 'off the shelf' improves theatre planning and turnaround.
- Space saving in the surgical environment
- Identification stickers for patient notes

### Optimization of consignment management

- Instruments and implants are stocked in tandem

### Staff & Patient safety

- Single use instruments reduce risk of incidents and cross contamination
- Changing blades is easy



Modular Consignment System

## O.S.2®-C & O.S.2®-V Static & Compression staples

A complete stand alone product for application of Compression staples, for fixation of arthrodeses, osteotomies and fractures in the foot.



### Compression Staple System

- The OS2 Staple is Pre-assembled and Sterile on the Inserter
- Including 2 K-Wires 2.5mm (70mm & 100mm)  
Set includes drill guide, depth gauge, inserter/impactor.
- The staple is manufactured in PEEK-OPTIMA
- Compression staples with an entraxis of 11 & 13mm have legs of 15/17mm long and staples with an entraxis of 15mm have legs of 11/13mm long.

### Static Staple System

- The O.S.2-V staple is delivered sterile pre-loaded on its inserter
- Available in 8 or 10mm interaxis with 2 available angles: 26° or 90°

## DuaFit® PIP Implants & Instrument set

### For Claw Toe, Hammer Toe, Mallet Toe

This original implant is indicated for the fixation of proximal inter-phalangeal joint arthrodesis of the lesser toes. DuaFit is available in 4 lengths (11, 14, 17, 20mm) and 3 different angulations (0° / 10° / 17°). Original 3 bladed design allows for easier insertion into the distal middle phalanx. The radio-transparent qualities of the PEEK-OPTIMA allow an easy control of the joint site.

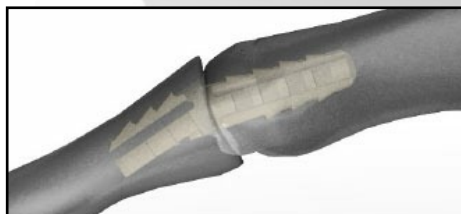
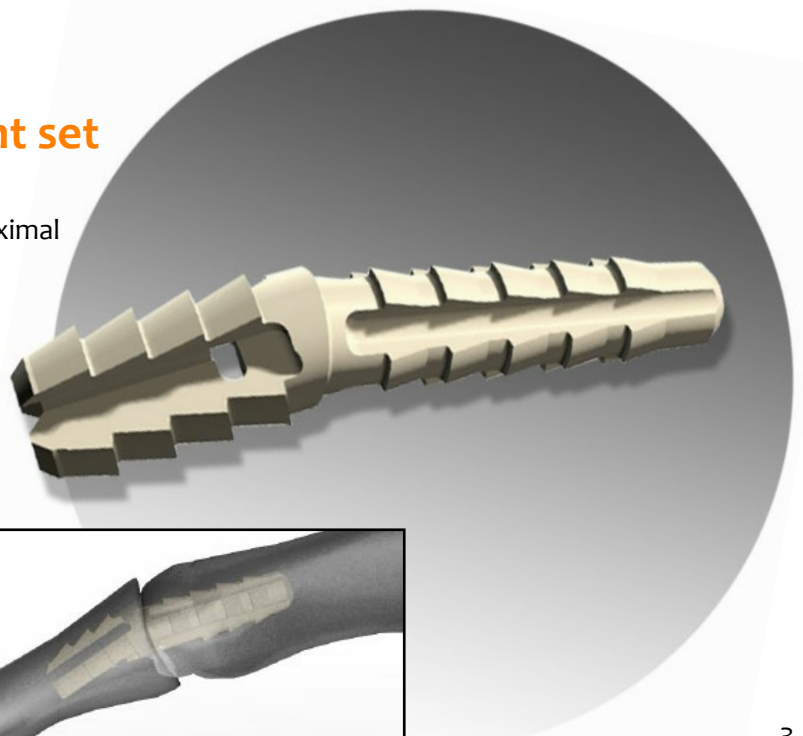

### Single Use Set comprises

- Gauge - measures P1
- Proximal canal taper - compatible 17° and 10°
- Distal canal taper - compatible 17° and 10°
- Implant holder - 0° / 10° / 17°

## NeoFit® MTP Implants & Instrument set for arthrodesis

A low profile, titanium plate (1.25mm) developed to maximise patient comfort, designed to avoid conflicts with surrounding tissue. It is a straight preformed plate, with compressive screw fixation through the oblong hole.

### Indications

- Hallux rigidus
- Severe hallux valgus (IM angle > 20° & HV angle > 40°)
- Deformity from rheumatoid arthritis
- Post traumatic arthritis
- Neuro muscular instability

### Benefits of NeoFit

- 3 sizes, right & left : L 40 mm (4 holes), L 45 mm (4 holes), 50 mm (4 holes)
- Locking or non Locking Screws
- 2 diameters : 2,7 mm / 3,0mm
- Metatarsal & phalangeal cannulated Reamers
- Reamers in 3 diameters
- Transfocal Screws
- Full Instrument sets
- K-Wires, assorted sizes

### Plate Bender

- Should it be required, the plate can be bent to match dorsal bone surface
- It is recommended to bend the plate only once



Reamers

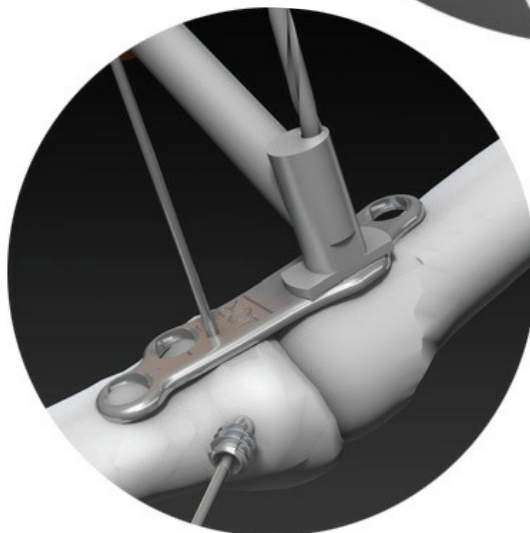

**FREE  
THEATRE  
TRIAL**

**Reusable and NEOSYS®**

**Single Use Systems**

Discover how these innovative new systems could benefit your clinical practice!

## Metal sets for Hire or on Consignment

Fully re-usable conventional metal sets are available as first line choice for surgery or as a backup system to the single use sets. They contain every instrument required for screw implants, staples, PIP implants & MTP arthrodesis.



**ATHRODAX**  
HEALTHCARE INTERNATIONAL LTD

Hawthorn Business Park, Drybrook, Gloucestershire GL17 9HP  
Telephone: (01594) 544440 Fax: (01594) 545800  
Email: sales@athrodax.co.uk Web: www.athrodax.co.uk



**No initial set up costs - FREE consignment sets**